

Installation of Snap/Lock Frame Aluminum Porch Panels

1. Measure the horizontal openings at the floor and header between vertical supports or posts. Cut the channels approximately $\frac{1}{2}$ " less than the opening's width. Install the "L" Channel on the floor and "C" channel to the header. You can install either the inside or outside "L" channel first depending on which direction you prefer to work. Drill $\frac{1}{4}$ " holes in the

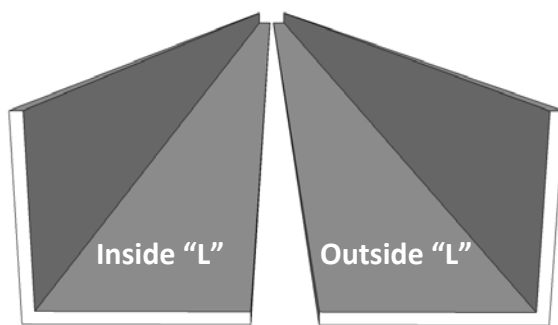

channels spaced approximately 36" apart and secure the channel with screws. The second "L" will be installed after the wall panels are fastened in place.

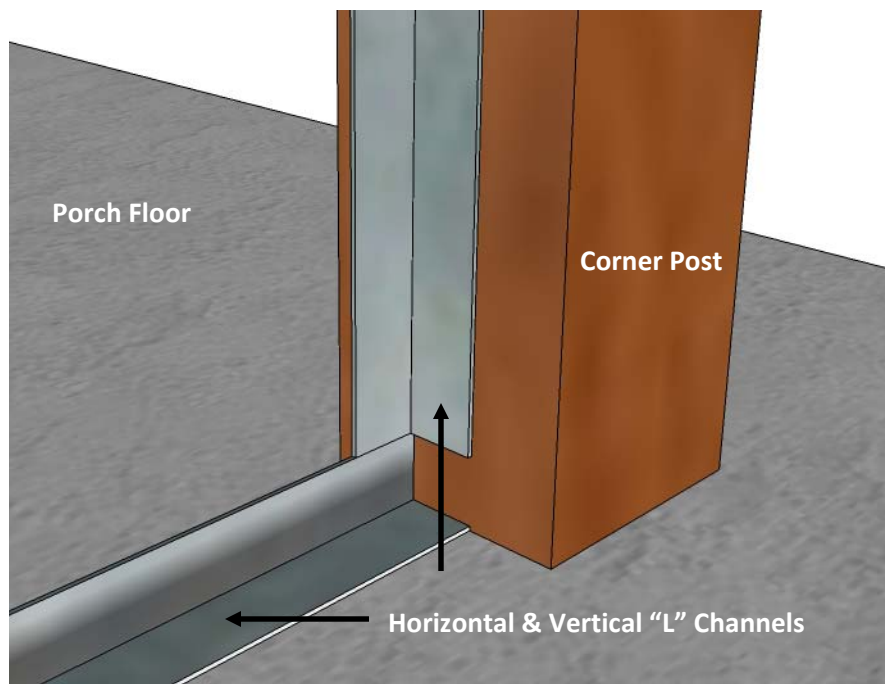

2. Measure the heights of the vertical supports between the horizontal receiving channels and cut the "C" and "L" channels. Install the "C" at one side and the "L" at the other.

3. When you have completely installed the perimeter channel, you can now snap the panels together and set them into the channels. Level the panels

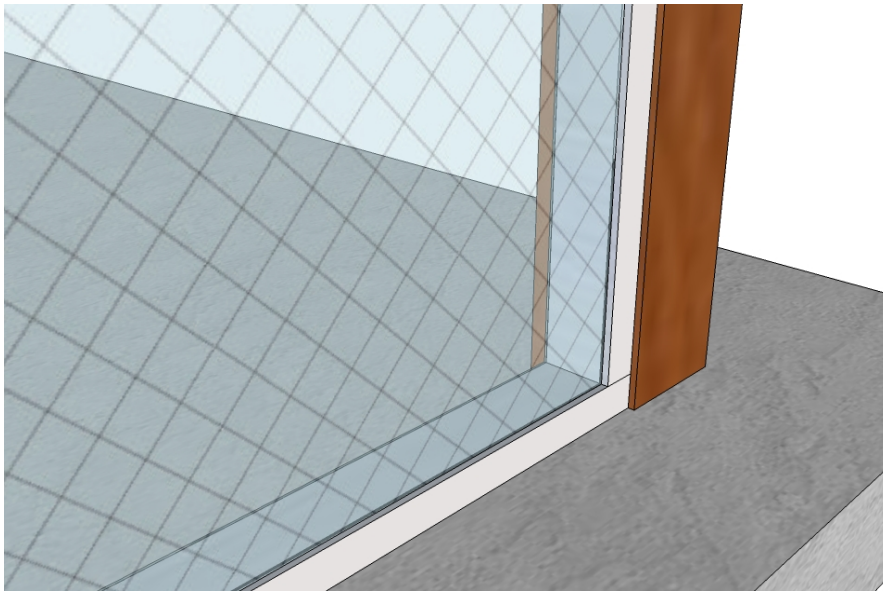

by shimming them at the bottom to the desired height. Make sure that the receiving channels do not cover the screen spline groove. Fasten the panels with Zip screws going through the channel and into the

panel. At this time use the screws sparingly, just enough to hold the panels in place.

4. When all frames are in place, install the second “L” channel which will act as a trim piece to finish off the installation and hide the space between the panel and the post, beam or deck.
5. Complete the installation of the Zip screws through the channels into the panels. The panels are shipped with the screening rolled loosely into the panel to avoid accidental tears. Remove the screen spline at the bottom and one side, pull the screen tight and replace the spline into the groove (this can be done prior to installation, if preferred).

RELAX AND ENJOY !



11801 Southwest Highway
Palos Heights, IL 60463
800-966-9261 * 708-931-5120 Fax